



FEDERAL COACH SPIRIT III BUS



Qualified Vehicle Modifier

Yesterday • Today • Tomorrow



*28 Passenger or 24 Passenger w/luggage
shown with optional 40" electrical bi-fold door*

Spirit-III



Every Federal Coach is custom handcrafted to meet the exact requirements of our valued clients. Features ranging from a co-pilot seat to decorative ceiling runners, front mounted TV/DVD players & unique overhead luggage systems are a few of the options that are available to you.

FEDERAL COACH

7400 South 28th Street • Fort Smith, AR 72908

Phone (479) 646-6800 • FAX (479) 646-1217

www.federalcoach.com • 800-292-6210

Things you need to know about Federal's Bus...

- ▶ **Altoona Tested for 7 Years/200,000 Miles** ▶ **Ford QVM**
- ▶ **Weight Compliance (28 Passenger or 24 Passenger w/luggage weight compliance depends on options selected)**
- ▶ **Building in Passenger Safety with Durability & Quality**

Federal Coach takes singular pride in the objective to engineer and produce the highest quality, safest & most desired vehicles in the market today.

SAFETY IS FIRST WITH FEDERAL COACH!



FEDERAL COACH SPIRIT III BUS SPECIFICATIONS

Dimensions

- Ceiling Height 76" 193cm
- Door Opening 32" W 81cm
- Exterior Height 110" 279cm
- Exterior Width 96 1/8" 244cm
- GVWR 14,500 lbs; 6577Kg

- Length 26'8" 813m
- Passenger Up to 28
(Subject to weight limitation)
- Turning Radius 32' 970cm
- Wheel Base 202" 513cm

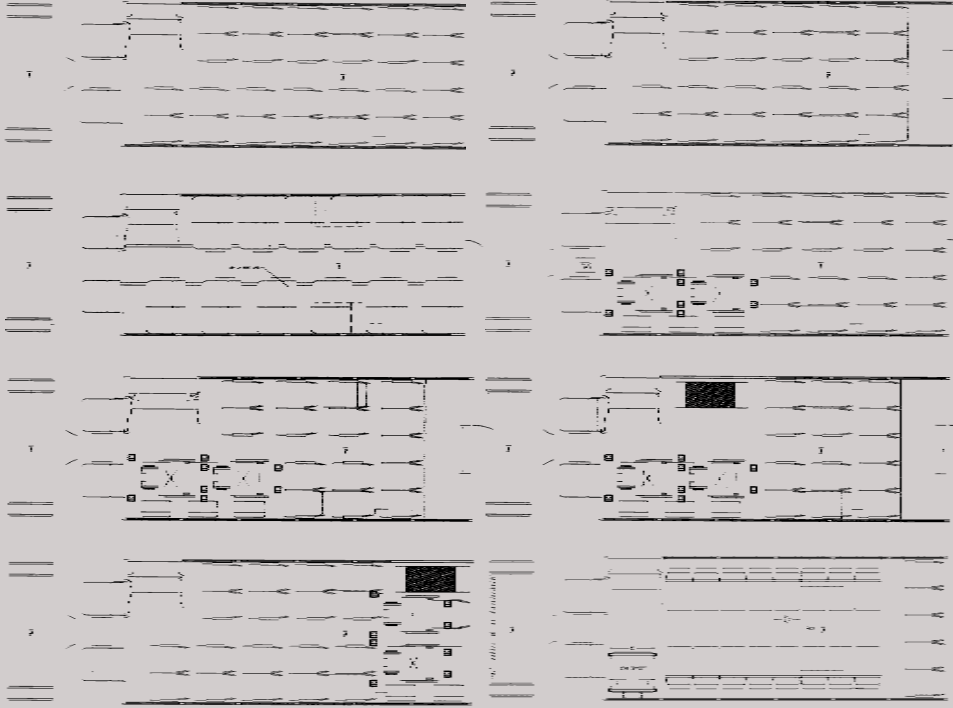

Additional Floor Plan Variations Available (See Your Local Dealer)

Standard Chassis Features

Ford E-Super Duty Cutaway E450 - 202" Wheelbase

- Air bags, Driver & Co-Pilot
- Alternator, 135AMP
- Batteries, Dual Heavy Duty
- Brakes, 4 Wheel Disc with ABS
- Bumper, Front Chrome
- Cooling System, Heavy Duty Engine Oil & Automatic Transmission Cooler
- Cruise Control
- Deluxe Insulation Package
- Dual Rear Wheels
- Engine, V-10 Gas Fuel Injected 6.8L
- Fuel tank, 55 Gallon
- Grill, Chrome
- Handling Package:
Front Stabilizer Bar
Heavy Duty Front & Rear Shock Absorbers
- Headlamps, Aerodynamic Halogen
- Power Door Locks
- Power Steering
- Power Windows
- Rubber Mat, Front Floor
- Seating, Driver & Co-Pilot
- Suspension, Twin I-Beam Independent Front with Caster Camber
- Tilt Steering Wheel
- Transmission, Electronic 5-Speed Automatic TorqShift™ Transmission
- Windshield Wiper (intermittent)

Optional Chassis

- Engine, 6.0L Power Stroke® Turbo Diesel w/dual Alternator System (140 & 120)
Specifications and option availability subject to change without notice.

Standard Conversion Features

- Alternator - PennTex 200AMP (Gas Only)
- Body, Primed Box Steel Frame
- Bumper, Rear, Heavy Duty (Painted)
- Door, Electric Bi-Fold Side Entry (32")
- Driveshaft Safety Loop
- Electrical Panel, Easy Access
- Fiberglass Skin
(Front & Rear Caps, Roof & Sides)
- Floor, 5/8" Exterior Grade Plywood
(Edge Sealed & Undercoated)
- Insulation, Fiberglass
- Lighting, Interior Dome (7)
- Lights, Stepwell (2)
- Lights, Tag
- Mirrors, Velvac, Manual Breakaway
- Modesty Panel with Entry Handrail
- Mudflaps, Front & Rear
- Paint, Exterior Body - White Gelcoat
- Undercoating, Soundproofing Frame and Structure
- Windows, Gloss Large Touring,
GL 20 Tint with Black-Out Trim

Optional Conversion Features

- 53,000 BTU Dual Compressor A/C System,
with 40,000 BTU Heat Coil
- 40,000 BTU Dual Compressor A/C with Heat Coil
- 35k, 40k or 60k BTU Under Seat Heaters
- 40" Electric Bi-Fold Door
- AM/FM Cassette, CD or Combination
- Back Up Alarm
- Back Up Monitor
- Cargo Net
- Ceiling Mount Handrails
- Ceiling Treatments
- DVD Player
- Exterior Key Entry
- Fiberglass Running Boards
- Flush Mount "Plug Door", Side Entry
- Full Rubber Floor
- Lighted Destination Sign
- Luggage Racks
- Overhead Luggage
- PA System
- Painted Skirts
- Rear Cargo Door with Glass
- Rear Side Wheelchair Lift & Accessories
- Remote Heated Mirrors
- Removable Rear Luggage Partition
- Right Hand Entry Handrails
- Roof Escape Hatch
- Seating, Freedman
- Stainless Wheel Covers w/Valve Stem Extensions
- Safety Equipment
- Television - LCD flat Screens - 19"
- UVL Stepwell Wheelchair Lift & Accessories

**Complete Optional List,
contact your local bus dealer or Federal Coach.**

For more information contact this Federal Coach Dealer.

